

WISENET

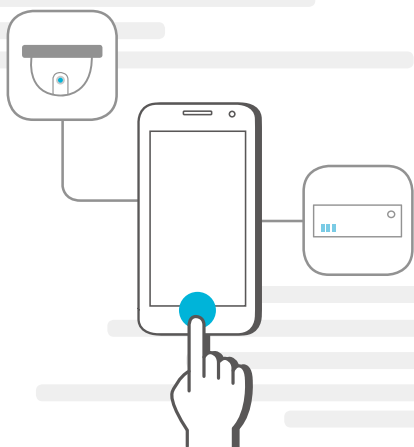

v1.4

WISENET mobile

User Manual



REGISTRATION

Registration

Auto Search for Devices

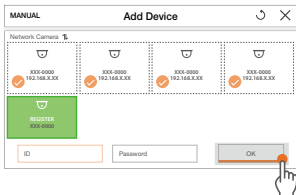

When the smartphone and the device are connected to the same Wi-Fi network

1. The list of devices that have been found will appear automatically.
 - When clicking [1.], you can select the method to sort the device list.
2. Enter the ID and the password, and click <OK>.
 - Devices that use the same ID and password can be added immediately.
3. Adding devices is complete.

Adding Devices Manually

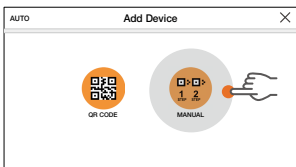

1. Click the manual button.
2. Enter the connection information, and click <OK>.
3. Adding devices is complete.

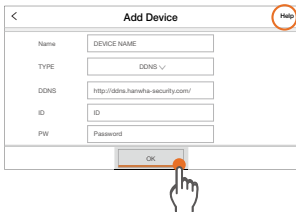

An explanation for each item is provided.

Adding Devices using a QR Code

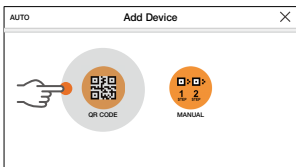

When the device has a QR code sticker attached

1. Click the QR code item.
2. Scan the QR code of the device with the smartphone.
3. Enter the ID and the password, and click <OK>.
4. Adding devices is complete.

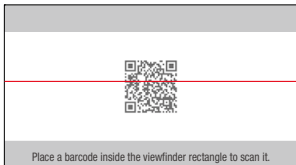



LIVE MONITORING

Live Monitoring Main Screen and Button Description

XXX-0000 - CAM01

When double-tapped, it will switch to 1-channel mode.

Split screen 1, 4, 9, 16

Add to My Channels
(It will be displayed on the top of the channel list)

Change channel

It is added to My Channels when the button [★] on the bottom of the live main channel is clicked, and it will be displayed on the top of the channel list.

CHANNEL LIST

MY CHANNELS

★ #1	★ #2	★ #3	★ #4
3CH	16CH	30CH	41CH

NVR

CAM 01	CAM 02	CAM 03	CAM 04	CAM 05	CAM 06	CAM 07
CAM 08	CAM 09	CAM 10	CAM 11	CAM 12	CAM 13	LIVE



LIVE MONITORING

1-Channel Mode Screen and Button Description

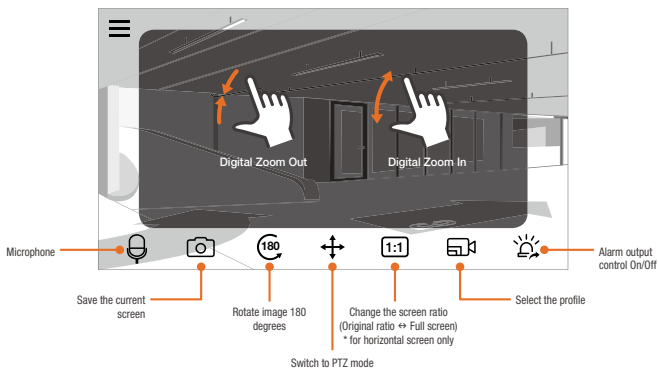

! Individual features may vary depending on the model.

PTZ Mode

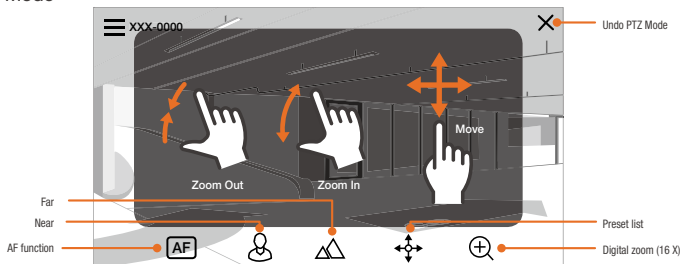

! If you keep your hand on when using pan tilt drag, it will keep moving in that direction.

! Individual features may vary depending on the model.

Fisheye Mode

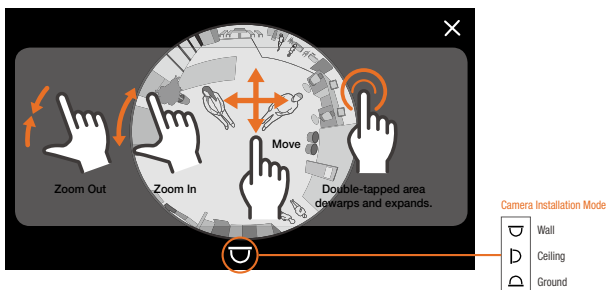



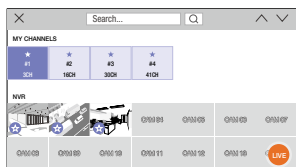

CHANNEL LIST

Channel List Screen



1. Move to the channel list by clicking [] on the top right of live monitoring.
2. Channel list can be searched when [] on the top right of the channel list screen is clicked.

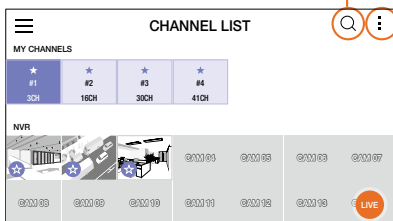

Press the button to move to the corresponding function.

1 Adding New Devices

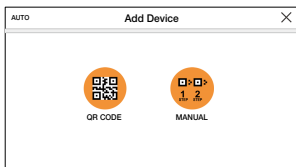

2 Modify Channel Information

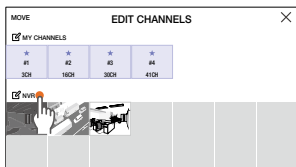

3 Showing the Device Name/Channel Name

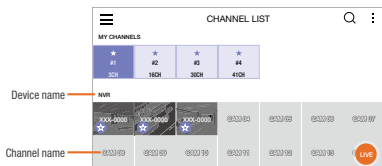

! When editing/deleting the connection information
Select the channel (thumbnail tile) if using the **Camera**.
Select the device name if using **NVR/DVR**.



SEARCH & PLAYBACK

Moving to the Playback Screen

From the Menu Button



In Live Monitoring screen

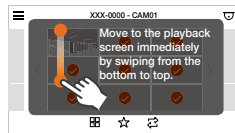

This works only from main view (refer to page 9).

Searching by Date/Time and Event

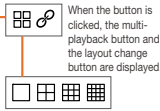
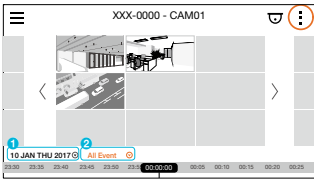

1 Date/Time Search



2 Event Search

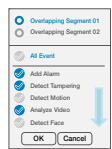

Only the dates with a saved image will be shown.

Timeline Screen Description in Detail

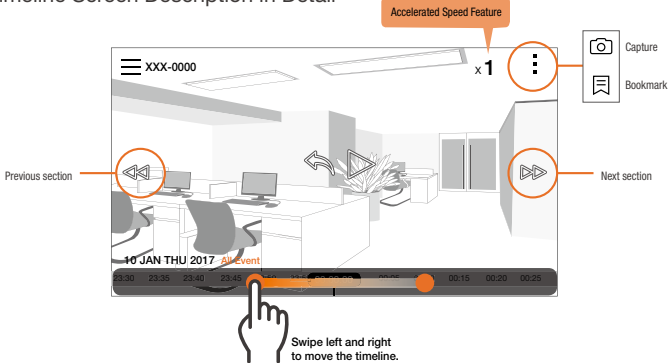

Searching the Bookmark

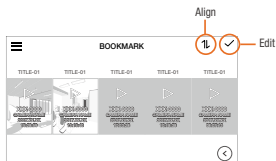
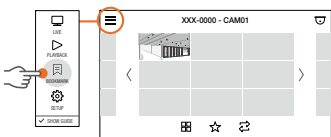



SEARCH & PLAYBACK

Event List

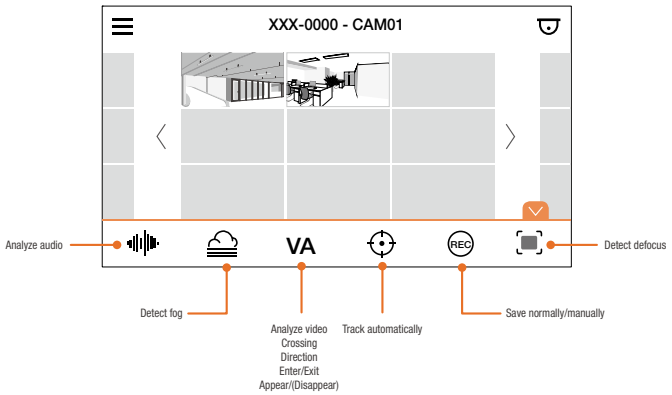
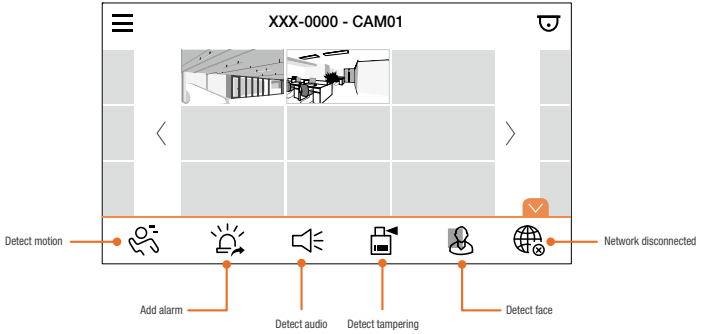

! Event types may vary depending on the model.



PUSH NOTIFICATION

Setting and Receiving Push Notifications

Settings

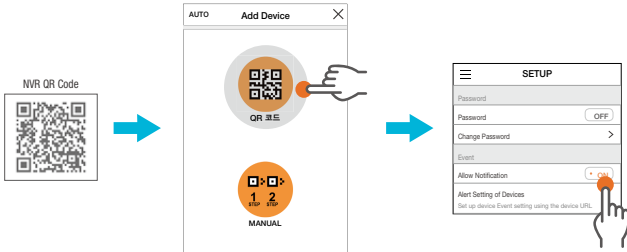

1. Register the QR code attached on NVR.
 - An NVR registered using a QR code can use push notifications.
2. When the registration is complete, set the **<Allow Notification>** item to **<ON>** after going to the settings screen.
3. Set the device to **<ON>** in the **<Device Setting>** item .

Receiving Push Notifications

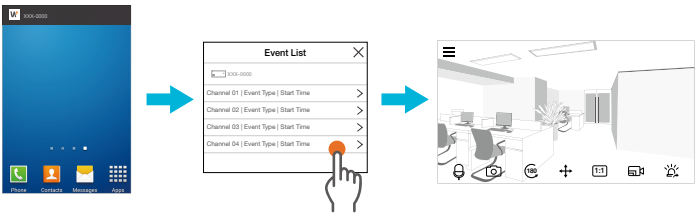

1. A push event receiving screen will appear when an event occurs.
 - It can be received after the **<Allow Notification>** item has been set in the Settings screen.
 - The view can vary according to the Event Push Notifications style the user has set in the mobile terminal.
2. Click on the event in the push event receiving screen.
3. It moves to the selected channel after running the app when the event is selected.



APPENDIX

Using Scenario



Full & Detail view rule



OPEN SOURCE AGREEMENT

OPEN SOURCE AGREEMENT

- GPL v 2.1 - Freeing
- BSD 2.0 - old cod
- MIT License - old cod, GPL, SAS, old cod, Newflow

GNU LESSER GENERAL PUBLIC LICENSE

Version 3, February 2002

Copyright © 2002 Free Software Foundation, Inc.
31 Franklin Street, Fifth Floor, Boston, MA 02110-1301 USA

Everyone is permitted to copy and distribute verbatim copies of this license document, but changing it is not allowed.

[This is the full text of the Lesser GPL. It also contains the text of the GNU General Public License, version 2, hence the version number 2.]

Preamble

The licenses for most software are designed to make sure you have the freedom to share it and to help others do the same. But the copyright holder for some software has made it impossible for you to do this. Your copyright here is your freedom to share it and to help others do the same. The licenses for most software are designed to make sure you have the freedom to share it and to help others do the same. The licenses for most software are designed to make sure you have the freedom to share it and to help others do the same. The licenses for most software are designed to make sure you have the freedom to share it and to help others do the same.

For example, you may copy and distribute copies of the software, but you must not put any additional restrictions on what others can do with the software. You may not charge a fee for the software, but you may charge a fee for the distribution of the software. You may not charge a fee for the software, but you may charge a fee for the distribution of the software.

For example, you may copy and distribute copies of the software, but you must not put any additional restrictions on what others can do with the software. You may not charge a fee for the software, but you may charge a fee for the distribution of the software. You may not charge a fee for the software, but you may charge a fee for the distribution of the software.

For example, you may copy and distribute copies of the software, but you must not put any additional restrictions on what others can do with the software. You may not charge a fee for the software, but you may charge a fee for the distribution of the software. You may not charge a fee for the software, but you may charge a fee for the distribution of the software.

Preamble

This license applies to any software library or other program which contains a notice placed by the copyright holder or other authorized party stating that its distribution under the terms of the Lesser General Public License (also called "this License") is authorized as described above. You may not charge a fee for the software, but you may charge a fee for the distribution of the software.

This license applies to any software library or other program which contains a notice placed by the copyright holder or other authorized party stating that its distribution under the terms of the Lesser General Public License (also called "this License") is authorized as described above. You may not charge a fee for the software, but you may charge a fee for the distribution of the software.

This license applies to any software library or other program which contains a notice placed by the copyright holder or other authorized party stating that its distribution under the terms of the Lesser General Public License (also called "this License") is authorized as described above. You may not charge a fee for the software, but you may charge a fee for the distribution of the software.

This license applies to any software library or other program which contains a notice placed by the copyright holder or other authorized party stating that its distribution under the terms of the Lesser General Public License (also called "this License") is authorized as described above. You may not charge a fee for the software, but you may charge a fee for the distribution of the software.

This license applies to any software library or other program which contains a notice placed by the copyright holder or other authorized party stating that its distribution under the terms of the Lesser General Public License (also called "this License") is authorized as described above. You may not charge a fee for the software, but you may charge a fee for the distribution of the software.

This license applies to any software library or other program which contains a notice placed by the copyright holder or other authorized party stating that its distribution under the terms of the Lesser General Public License (also called "this License") is authorized as described above. You may not charge a fee for the software, but you may charge a fee for the distribution of the software.

This license applies to any software library or other program which contains a notice placed by the copyright holder or other authorized party stating that its distribution under the terms of the Lesser General Public License (also called "this License") is authorized as described above. You may not charge a fee for the software, but you may charge a fee for the distribution of the software.

This license applies to any software library or other program which contains a notice placed by the copyright holder or other authorized party stating that its distribution under the terms of the Lesser General Public License (also called "this License") is authorized as described above. You may not charge a fee for the software, but you may charge a fee for the distribution of the software.

This license applies to any software library or other program which contains a notice placed by the copyright holder or other authorized party stating that its distribution under the terms of the Lesser General Public License (also called "this License") is authorized as described above. You may not charge a fee for the software, but you may charge a fee for the distribution of the software.

It may happen that the equipment contains the license restrictions of other proprietary licenses that do not normally accompany the operating system. Such a combination may prevent you from installing the GNU Library together with an executable binary program. However, parties who have received copies of rights from the Library will not have their licenses terminated as long as such parties remain in full compliance.

You may place binary libraries that are a work based on the Library side-by-side in a single binary together with other libraries not covered by the License, and distribute such a combined binary provided the separate distribution of the work based on the Library and of the other library libraries is permitted, and provided that you do not have to keep.

Accompany the combined binary with a copy of the same work based on the Library, unchanged with any other library facilities. This must be distributed under the terms of the Sections above.

As a consequence of a court judgment or arbitration proceeding or for any other reason not limited to patent claims, the recipient exercises of the rights granted here. You may not be responsible for enforcing compliance with the terms and conditions of the recipient's exercise of the rights granted here.

It is not the purpose of this license to restrict your freedom to improve the software. You may not charge a fee for the software, but you may charge a fee for the distribution of the software. You may not charge a fee for the software, but you may charge a fee for the distribution of the software.

It is not the purpose of this license to restrict your freedom to improve the software. You may not charge a fee for the software, but you may charge a fee for the distribution of the software. You may not charge a fee for the software, but you may charge a fee for the distribution of the software.

END OF TERMS AND CONDITIONS

How to Apply These Terms to Your New Libraries

If you develop a new library, and you want to be the greatest possible benefit to the public, we recommend making it a free software that anyone can redistribute and change. You do so by permitting distribution under these terms (or, alternatively, under the terms of the GNU General Public License).

This library is distributed in the hope that it will be useful, but WITHOUT ANY WARRANTY, without even the implied warranty of MERCHANTABILITY or FITNESS FOR A PARTICULAR PURPOSE. See the GNU Lesser General Public License for more details.

Redistribution and use in source and binary forms, with or without modifications, are permitted provided that the following conditions are met: Redistribution of source code must retain the above copyright notice, this list of conditions and the following disclaimer.

Redistribution of source code must retain the above copyright notice, this list of conditions and the following disclaimer. Redistribution of binary form must reproduce the above copyright notice, this list of conditions and the following disclaimer in the documentation and/or other materials provided with the distribution.

Redistribution of source code must retain the above copyright notice, this list of conditions and the following disclaimer. Redistribution of binary form must reproduce the above copyright notice, this list of conditions and the following disclaimer in the documentation and/or other materials provided with the distribution.

Redistribution of source code must retain the above copyright notice, this list of conditions and the following disclaimer. Redistribution of binary form must reproduce the above copyright notice, this list of conditions and the following disclaimer in the documentation and/or other materials provided with the distribution.

Redistribution of source code must retain the above copyright notice, this list of conditions and the following disclaimer. Redistribution of binary form must reproduce the above copyright notice, this list of conditions and the following disclaimer in the documentation and/or other materials provided with the distribution.

Redistribution of source code must retain the above copyright notice, this list of conditions and the following disclaimer. Redistribution of binary form must reproduce the above copyright notice, this list of conditions and the following disclaimer in the documentation and/or other materials provided with the distribution.

Redistribution of source code must retain the above copyright notice, this list of conditions and the following disclaimer. Redistribution of binary form must reproduce the above copyright notice, this list of conditions and the following disclaimer in the documentation and/or other materials provided with the distribution.

Head Office

6, Pangyo-ro 319 beon-gil, Bundang-gu, Seongnam-si,
Gyeonggi-do, 463-400 Rep. of KOREA
Tel : +82.70.7147.8753 Fax : +82.31.8018.3740
www.hanwha-security.com

Hanwha Techwin America

500 Frank W. Burr Blvd. Suite 43 Teaneck, NJ 07666
Toll Free +1.877.213.1222 Direct +1.201.325.6920
Fax +1.201.373.0124
www.hanwhasecurity.com

Hanwha Techwin Europe

Heriot House, Heriot Road, Chertsey, Surrey, KT16 9DT, United Kingdom
Tel +44.1932.57.8100 Fax +44.1932.57.8101
www.hanwha-security.eu
