

Accessory Bag	
8pcs	2pcs
M5 x 7.5L	M4 x 4L

## 2. Installation Tasks

Installing a Friction Slide-rail kit involves performing the following tasks in their numbered order:

- ① Removing the rack doors
- ② Marking the rack
- ③ Installing the slide assemblies in the rack:
  - Friction Slide-rail installation
- ④ Installing the system in the rack
- ⑤ Replacing the rack doors

Removing the rack doors:

See the procedures for removing doors in the documentation provided with your rack cabinet.

**▲ CAUTION:** Because of the size and weight of the rack cabinet doors, never attempt to remove or install them by yourself.  
**CAUTION:** Store the two doors where they will not injure someone if the doors accidently fall over.

## 3. Rack Unit Type

Rack cabinets may have round or square holes with an alternating pattern of three holes per rack unit with center-to-center hole spacing (beginning at the top hole of a 1-U space) of 15.9mm, 15.9mm, and 12.7mm (0.625 inch, 0.625 inch, and 0.5 inch) for the front and back vertical rails.

Note : You must allow : 1-U(44mm, or 1.75 inches) of vertical space for 1U chassis.  
 2-U(88mm, or 3.5 inches) of vertical space for 2U chassis.

One Rack Unit

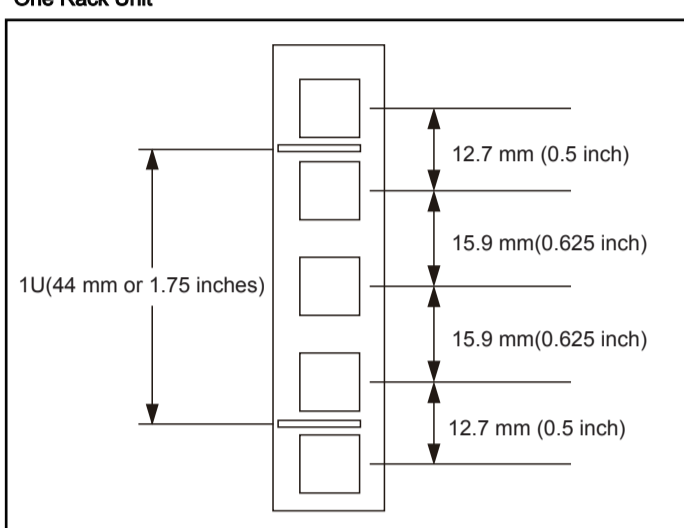

Two-Post, Open-Frame Relay Rack Universal-Hole Spacing

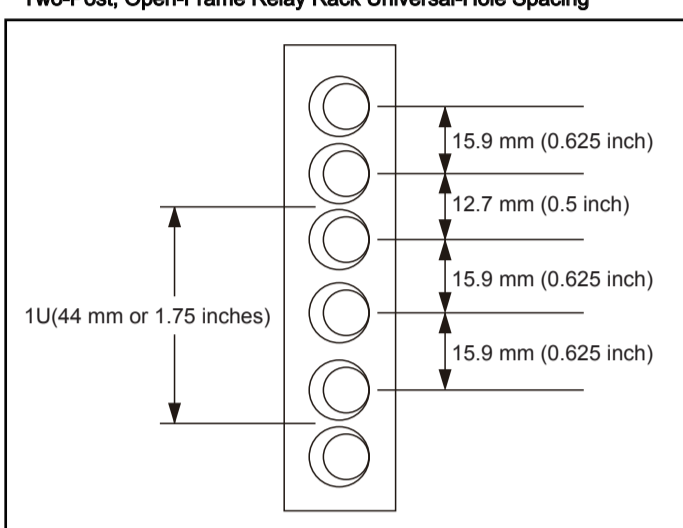

## 4. Marking the Vertical Rails

- ① At the front of the rack cabinet, position one of the friction slide assemblies so that its mounting-bracket flange fits between the marks or tape (or numbered location) on the rack. The two holes on the front of the mounting bracket should align with two of the holes between the marks you made on the front vertical rail.

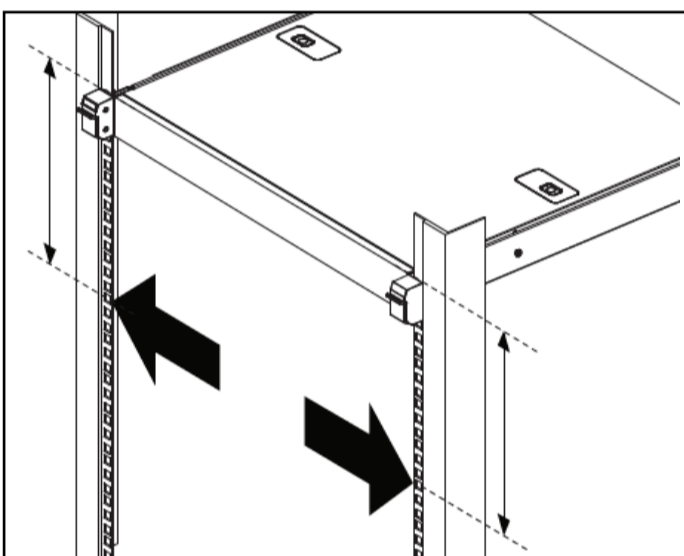

## 5. Installing the Friction Slide Assemblies

- ① Secure the slide assembly to the front vertical rail with two screws as shown.

**▲ CAUTION:** Ensure that the slide assemblies are mounted at the same position on the vertical rails on each side of the rack.

- ② At the back of the cabinet, pull back on the mounting-bracket flange until the mounting holes align with their respective holes on the back vertical rail.

- ③ Secure the slide assembly to the rear vertical rail with two screws as shown.

- ④ Repeat above steps of the slide assembly on the other side of the rack.

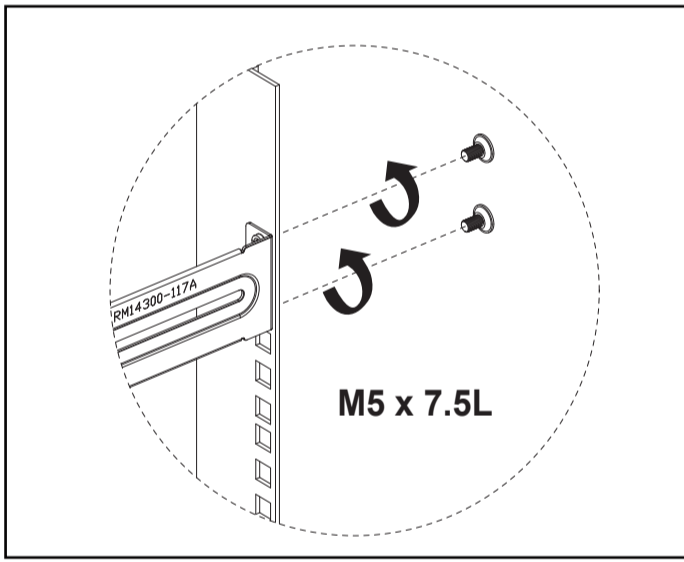
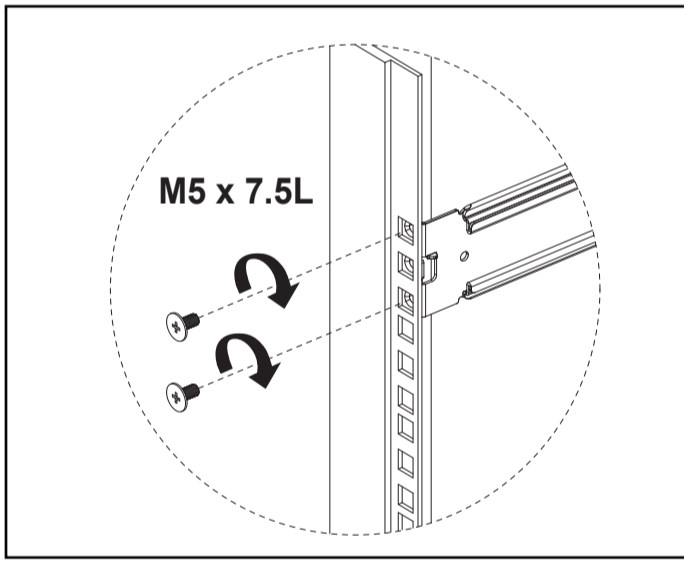

## 6. Installing the System in the Rack

- ① Pull the slide-rail outward in fully extended position.

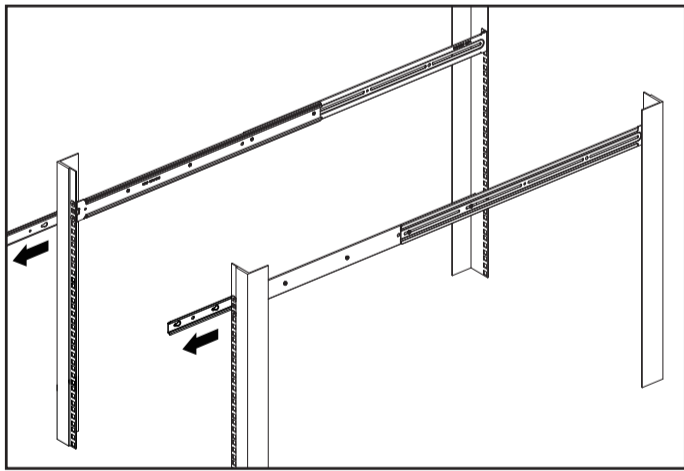

- ② Lift up the slide release latch to remove the inner rail.

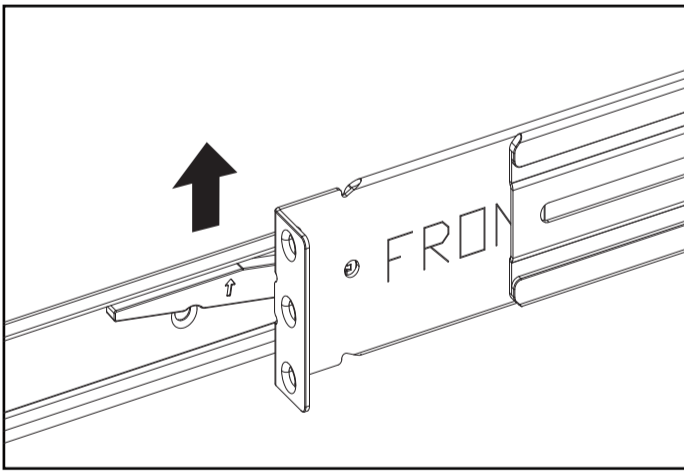

- ③ Attach the inner rail with the system while aligning the back shoulder screws on the side of the system with the back slots on the inner rail.

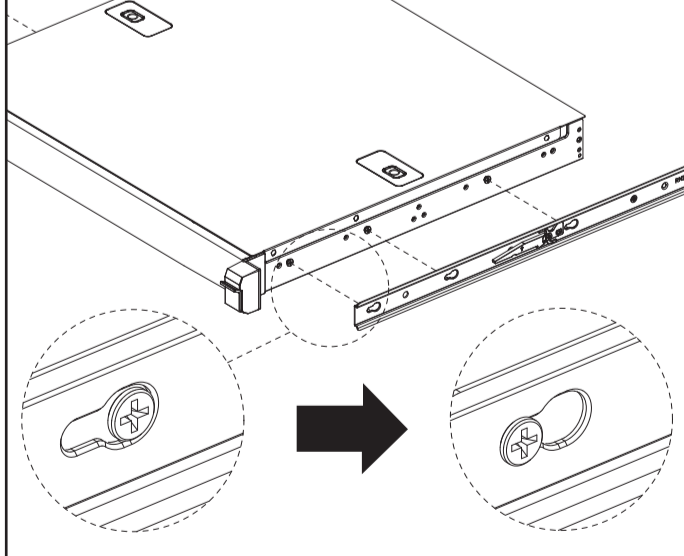

- ④ Engage the back shoulder screws into their slots and secure with screw as shown.

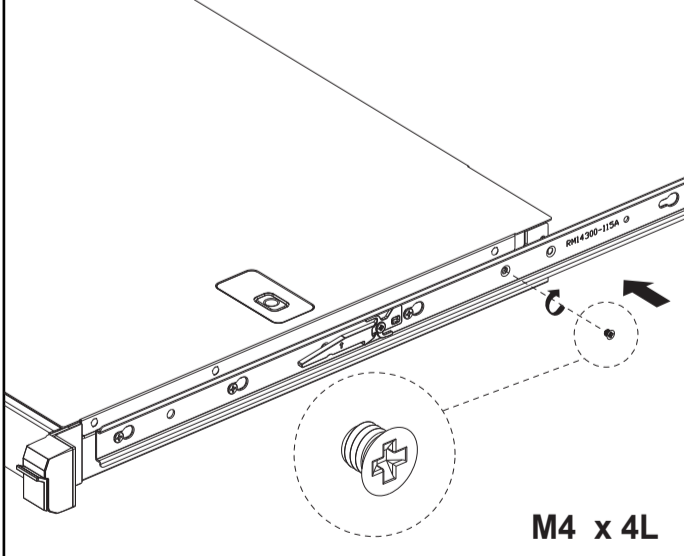

- ⑤ Repeat above steps of inner rail installing on the other side of the system.
- ⑥ Carefully install the system into the rack with two hands.

## 7. Remove the System Away From the Rack

- ① Pull the system out of the rack until they lock in the fully extended position.

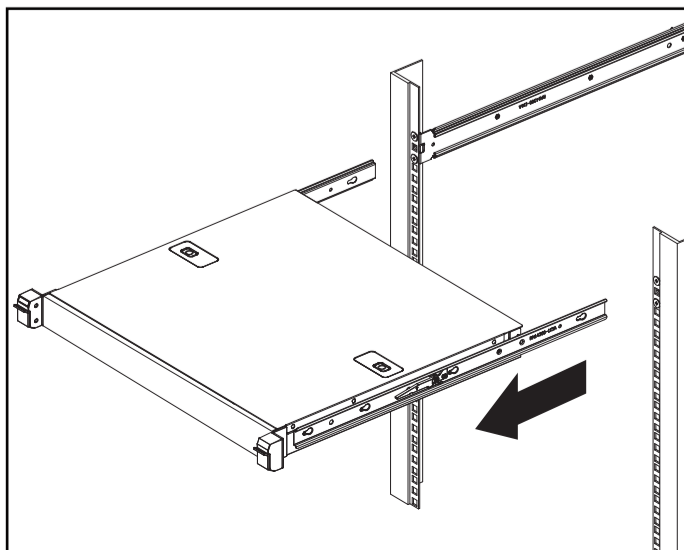

- ② Lift up the system release latch on both side of the rack and carefully pull the system outward with two hands.

